

NomiStar Inc

247 Frelinghuysen Ave
 Newark, NJ 07114
 Phone: 973-424-0909/877-424-090
 Fax: 973-424-9090/800-854-0296
 Email: info.nj@nomistar.net



NomiStar Inc

1043 N Lombard Rd
 Lombard, IL 60148
 Phone: 630-261-9300/877-261-9333
 Fax: 630-261-0061/866-633-7755
 Email: info.il@nomistar.net

Roller Shades - Chart 1

Material	Openness	Composition
Matte/Moire/Boucle	BO	Fiberglass/PVC

L e n g t h	Width												Side Channels
	24	36	48	60	72	84	96	108	120	132	144	156	
36	70	89	109	127	164	189	199	253	444	483	526	716	59
48	77	98	120	141	181	210	221	350	446	488	529	721	79
60	85	109	133	157	197	232	270	352	449	490	531	724	99
72	91	118	144	170	216	252	293	353	450	492	533	725	119
84	97	128	158	186	233	275	313	369	570	626	676	889	139
96	119	153	187	220	252	299	338	526	575	633	684	900	158
108	127	163	199	235	270	320	360	527	576	635	688	904	178
120	141	176	212	250	288	342	382	529	580	640	692	908	198
132	166	205	245	288	330	390	403	626	686	757	821	1055	218
144	172	215	257	302	348	412	426	627	691	761	824	1058	238
156	198	250	302	358	414	491	511	635	699	857	928	1074	257

Roller Shades - Chart 2

Material	Openness	Composition
SheerWeave 1000	25%	Fiberglass/Vinyl
SheerWeave 3000	14%	Fiberglass/Polyster/Vinyl

L e n g t h	Width												Side Channels
	24	36	48	60	72	84	96	108	120	132	144	156	
36	81	103	126	147	189	219	230	293	513	559	608	829	59
48	89	113	139	164	210	243	256	405	515	564	611	833	79
60	98	126	155	181	228	268	312	407	519	566	614	836	99
72	105	136	167	197	249	292	338	409	521	569	617	839	119
84	113	148	182	215	269	318	363	427	659	723	781	1029	139
96	138	177	216	254	292	346	391	608	665	732	791	1041	158
108	147	189	230	272	311	370	417	610	666	734	795	1045	178
120	164	203	245	289	333	395	441	612	670	740	800	1050	198
132	191	238	283	333	382	451	466	724	793	876	950	1220	218
144	199	248	297	349	402	477	492	725	799	879	953	1223	238
156	229	289	349	414	478	568	591	734	809	990	1073	1242	257

NomiStar Inc.

247 Frelinghuysen Ave
 Newark, NJ 07114
 Phone: 973-424-0909/877-424-090
 Fax: 973-424-9090/800-854-0296
 Email: info.nj@nomistar.net



NomiStar Inc.

1043 N Lombard Rd
 Lombard, IL 60148
 Phone: 630-261-9300/877-261-9333
 Fax: 630-261-0061/866-633-7755
 Email: info.il@nomistar.net

Roller Shades - Chart 3

Material	Openness	Composition
SheerWeave 2000/2390/2705	5%	Fiberglass/Vinyl
SheerWeave 2100/2360/2710	10%	Fiberglass/Vinyl
SheerWeave 4000	5%	Polyester/Vinyl
SheerWeave 4100	10%	Polyester/Vinyl

L e n g t h	Width												Side Channels
	24	36	48	60	72	84	96	108	120	132	144	156	
36	88	113	138	160	207	239	251	320	561	610	663	905	59
48	98	124	151	178	229	265	279	442	563	616	668	911	79
60	107	138	168	198	248	293	341	444	567	618	671	914	99
72	115	149	183	215	273	319	370	446	569	621	673	916	119
84	123	161	199	235	294	347	396	466	719	789	853	1123	139
96	150	194	236	277	319	378	427	663	726	798	864	1137	158
108	160	206	251	297	340	404	455	666	728	802	868	1141	178
120	178	222	267	316	365	431	482	669	732	807	874	1147	198
132	209	259	309	364	417	492	509	790	866	956	1037	1331	218
144	217	272	324	382	439	520	537	792	872	960	1040	1336	238
156	249	316	382	453	522	620	646	802	883	1082	1172	1356	257

Roller Shades - Chart 4

Material	Openness	Composition
SheerWeave 2410/2703	3%	Fiberglass/Vinyl
SheerWeave 4400	3%	Polyester/Vinyl

L e n g t h	Width												Side Channels
	24	36	48	60	72	84	96	108	120	132	144	156	
36	94	118	145	169	218	251	265	337	590	643	698	953	59
48	103	131	159	188	241	279	293	466	592	649	703	959	79
60	113	145	177	208	262	309	359	468	597	652	707	962	99
72	122	157	192	227	287	336	389	470	599	654	709	965	119
84	130	170	209	248	310	365	417	491	758	832	898	1183	139
96	158	203	248	292	336	398	449	698	764	842	910	1197	158
108	169	217	265	312	358	426	479	701	767	845	914	1202	178
120	188	234	282	333	383	455	507	704	770	851	921	1208	198
132	220	274	325	383	439	518	536	833	912	1007	1092	1402	218
144	229	286	341	401	463	548	566	834	919	1012	1096	1407	238
156	263	333	401	476	550	653	680	845	930	1139	1234	1428	257

NomiStar Inc.

247 Frelinghuysen Ave
 Newark, NJ 07114
 Phone: 973-424-0909/877-424-090
 Fax: 973-424-9090/800-854-0296
 Email: info.nj@nomistar.net



NomiStar Inc.

1043 N Lombard Rd
 Lombard, IL 60148
 Phone: 630-261-9300/877-261-9333
 Fax: 630-261-0061/866-633-7755
 Email: info.il@nomistar.net

Roller Shades - Chart 5

Material	Openness	Composition
SheerWeave 2500/2701	1%	Fiberglass/Vinyl
SheerWeave 4800	1%	Polyster/Vinyl

L e n g t h	Width												Side Channels
	24	36	48	60	72	84	96	108	120	132	144	156	
36	101	128	157	183	235	272	286	364	638	695	754	1030	59
48	111	141	172	203	260	302	317	503	640	701	760	1036	79
60	122	157	192	225	283	334	389	505	645	704	763	1040	99
72	131	169	207	245	310	363	420	508	647	707	766	1042	119
84	140	184	226	267	335	394	450	530	819	898	971	1278	139
96	171	220	268	315	363	430	486	754	826	909	983	1293	158
108	183	234	286	338	387	460	518	758	828	913	987	1299	178
120	203	253	304	359	414	491	548	761	833	919	995	1305	198
132	238	295	351	413	474	560	580	899	986	1088	1180	1515	218
144	247	309	369	434	500	592	612	902	993	1093	1184	1520	238
156	284	359	434	515	594	706	735	913	1005	1230	1333	1543	257

Roller Shades - Chart 6

Material	Openness	Composition
SheerWeave 5000	Varies by Color	Fiberglass/PVC

L e n g t h	Width												Side Channels
	24	36	48	60	72	84	96	108	120	132	144	156	
36	101	128	157	183	235	272	286	Due to pattern, this fabric should not be railroaded. Please contact GG Royal for further assistance.					59
48	111	141	172	203	260	302	317						79
60	122	157	192	225	283	334	389						99
72	131	169	207	245	310	363	420						119
84	140	184	226	267	335	394	450						139
96	171	220	268	315	363	430	486						158
108	183	234	286	338	387	460	518						178
120	203	253	304	359	414	491	548						198
132	238	295	351	413	474	560	580						218
144	247	309	369	434	500	592	612						238
156	284	359	434	515	594	706	735						257

NomiStar Inc.

247 Frelinghuysen Ave
 Newark, NJ 07114
 Phone: 973-424-0909/877-424-090
 Fax: 973-424-9090/800-854-0296
 Email: info.nj@nomistar.net



NomiStar Inc.

1043 N Lombard Rd
 Lombard, IL 60148
 Phone: 630-261-9300/877-261-9333
 Fax: 630-261-0061/866-633-7755
 Email: info.il@nomistar.net

Roller Shades - Chart 7

Material	Openness	Composition
SheerWeave 7100	BO	Fiberglass/PVC

L e n g t h	Width												Side Channels
	24	36	48	60	72	84	96	108	120	132	144	156	
36	105	133	163	190	245	283	297	378	662	722	785	1070	59
48	116	147	179	212	270	313	329	523	665	728	790	1076	79
60	127	163	199	234	294	347	403	526	671	731	793	1080	99
72	136	176	215	255	323	376	437	527	672	735	796	1083	119
84	146	191	236	278	348	410	468	551	851	934	1009	1328	139
96	178	229	280	329	376	446	506	785	859	945	1022	1344	158
108	190	244	297	351	403	479	538	788	860	949	1027	1349	178
120	212	264	318	374	430	511	570	790	866	956	1033	1355	198
132	248	307	365	430	493	582	602	935	1024	1130	1226	1575	218
144	257	321	383	452	520	616	635	937	1032	1136	1231	1580	238
156	296	374	452	536	618	734	763	949	1044	1279	1385	1603	257

Roller Shades - Chart 8

Material	Openness	Composition
SheerWeave 7000	BO	Polyester/Acrylic Backing

L e n g t h	Width												Side Channels
	24	36	48	60	72	84	96	108	120	132	144	156	
36	137	174	212	248	320	369	389	494	867	944	1026	1400	59
48	151	192	234	276	354	410	431	684	869	952	1032	1409	79
60	165	212	261	306	384	454	527	687	877	957	1037	1412	99
72	177	230	282	332	421	492	572	689	879	961	1041	1417	119
84	190	249	307	364	455	536	612	720	1112	1221	1319	1737	139
96	232	299	365	428	492	584	660	1026	1122	1235	1337	1759	158
108	248	319	389	459	527	625	704	1030	1125	1241	1342	1765	178
120	276	344	414	489	563	667	744	1034	1131	1249	1352	1774	198
132	322	401	477	562	644	761	788	1222	1339	1479	1604	2059	218
144	335	419	501	590	680	805	832	1225	1349	1485	1609	2066	238
156	386	489	590	699	807	959	999	1241	1366	1672	1812	2097	257

NomiStar Inc.

247 Frelinghuysen Ave
 Newark, NJ 07114
 Phone: 973-424-0909/877-424-090
 Fax: 973-424-9090/800-854-0296
 Email: info.nj@nomistar.net



NomiStar Inc.

1043 N Lombard Rd
 Lombard, IL 60148
 Phone: 630-261-9300/877-261-9333
 Fax: 630-261-0061/866-633-7755
 Email: info.il@nomistar.net

Roller Shades - Chart 9

Material	Openness	Composition
SheerWeave Infinity	5%	Poly-Olefin

L e n g t h	Width												Side Channels
	24	36	48	60	72	84	96	108	120	132	144	156	
36	159	202	248	288	372	429	452	575	1008	1098	1193	1629	59
48	176	223	272	321	411	477	501	796	1012	1108	1202	1638	79
60	192	248	303	356	447	527	614	799	1020	1113	1206	1643	99
72	207	267	328	387	490	573	665	802	1023	1118	1211	1648	119
84	221	290	357	423	529	624	712	838	1295	1421	1535	2021	139
96	270	347	424	498	573	680	768	1193	1306	1437	1555	2046	158
108	288	370	452	534	612	727	819	1198	1310	1444	1562	2054	178
120	321	400	482	568	655	776	866	1203	1316	1454	1573	2064	198
132	375	467	555	653	750	886	917	1422	1558	1720	1866	2396	218
144	390	488	583	686	791	936	968	1426	1570	1728	1872	2404	238
156	449	568	686	814	940	1116	1162	1444	1589	1946	2108	2440	257

Roller Shades - Chart 10

Material	Openness	Composition
SheerWeave Infinity	3%	Poly-Olefin

L e n g t h	Width												Side Channels
	24	36	48	60	72	84	96	108	120	132	144	156	
36	175	221	272	317	409	472	497	632	1109	1208	1312	1791	59
48	193	245	299	353	452	524	551	875	1112	1219	1321	1802	79
60	211	272	333	391	491	580	675	878	1121	1224	1327	1807	99
72	227	293	360	425	538	630	731	882	1125	1229	1332	1813	119
84	243	319	392	464	581	686	783	922	1424	1562	1688	2223	139
96	297	382	466	547	630	747	844	1312	1436	1580	1710	2250	158
108	317	407	497	587	673	799	900	1318	1440	1588	1717	2259	178
120	353	439	529	625	720	853	952	1323	1447	1598	1730	2270	198
132	412	513	610	718	824	974	1008	1564	1714	1892	2052	2635	218
144	428	536	641	754	869	1030	1064	1568	1726	1901	2059	2644	238
156	493	625	754	895	1033	1228	1278	1588	1748	2140	2318	2684	257

NomiStar Inc.

247 Frelinghuysen Ave
Newark, NJ 07114
Phone: 973-424-0909/877-424-090
Fax: 973-424-9090/800-854-0296
Email: info.nj@nomistar.net



NomiStar Inc.

1043 N Lombard Rd
Lombard, IL 60148
Phone: 630-261-9300/877-261-9333
Fax: 630-261-0061/866-633-7755
Email: info.il@nomistar.net

Roller Shades – Valance Options

	Width											
	24	36	48	60	72	84	96	108	120	132	144	156
Standard Valance	20	25	31	36	41	47	52	58	63	68	74	79
Fascia	38	47	56	65	74	83	92	101	110	119	128	137
Cassette	76	94	112	130	148	166	184	202	220	238	256	274

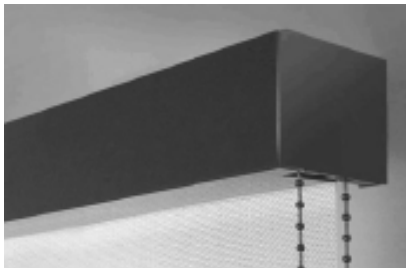

Fascia
Available in 3" & 4"
Regular Roll Only
No Fabric Insert

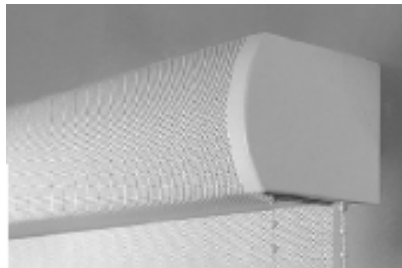

Cassette
Available in 3" & 4"
Regular Roll Only
Fabric Insert

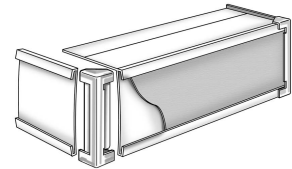

Standard Valance
Regular &
Reverse Roll
3.5" Fabric Insert

Color Options

*Clutches are available in the following colors:

Black; Ivory (default); and White

*Cassettes and Fascias are available in the following colors:

Black; Bronze; Ivory; Silver; White

**If a specific color is desired for any option, including clutches, please notify us at the time of order or quote, otherwise cassettes and fascias will be matched to the fabric selection.

NomiStar Inc.

247 Frelinghuysen Ave
Newark, NJ 07114
Phone: 973-424-0909/877-424-090
Fax: 973-424-9090/800-854-0296
Email: info.nj@nomistar.net



NomiStar Inc.

1043 N Lombard Rd
Lombard, IL 60148
Phone: 630-261-9300/877-261-9333
Fax: 630-261-0061/866-633-7755
Email: info.il@nomistar.net

Sill Channel

		Width											
		24	36	48	60	72	84	96	108	120	132	144	156
Sill Channel		20	30	40	50	59	69	79	89	99	109	119	129

Side and Sill Channels are used to eliminate light gaps between the roller shade fabric and window frame.

For side channels please refer to the charts on the previous pages.

Side and Sill Channels are available in white or ivory only.

Hembar Options

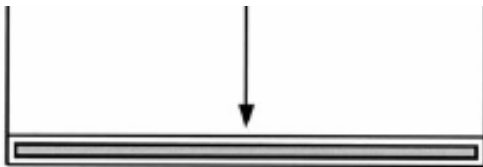

Standard Pocket

Wood or Aluminum Hembar is heat sealed Inside the pocket

Sealed at ends only if specified.



External Hembar

Available in: Black; Bronze; Ivory; Silver; & White

GG Royal will match the external hembar to the fabric, unless otherwise specified

\$4 Net charge per shade

NomiStar Inc.

247 Frelinghuysen Ave
Newark, NJ 07114
Phone: 973-424-0909/877-424-090
Fax: 973-424-9090/800-854-0296
Email: info.nj@nomistar.net



NomiStar Inc.

1043 N Lombard Rd
Lombard, IL 60148
Phone: 630-261-9300/877-261-9333
Fax: 630-261-0061/866-633-7755
Email: info.il@nomistar.net

Important Notes

- *ALL measurements MUST be bracket to bracket. Fabric sizes will not be accepted. Factory will make all deductions needed.
 - *Shades will be fabricated vertically or horizontally (railroaded) at factory's discretion. Please specify preference at the time of order or quote.
 - *Shades wider and longer than the fabric's roll width will have one or more seams. If a specific seam height is required, please specify the location from the bottom of the shade up. Allow +/- 1"
 - *Size of shade will determine clutch and tube used, upgrades can be made upon request (surcharges may apply). Please refer to the "Clutch Selection Guide" at the back of the price list.
 - *Reverse roll option is not available with fascia and cassette.
 - *Shades that are larger than a 3:1 ratio (height to width = height is three times longer than the width) may be susceptible to telescoping.
 - *Need something not in our price list, please contact GG Royal for additional fabric selections.
- **Motorization** – GG Royal Roller Shades are now powered by Somfy. Please contact our offices for more details.

NomiStar Inc.

247 Frelinghuysen Ave
Newark, NJ 07114
Phone: 973-424-0909/877-424-090
Fax: 973-424-9090/800-854-0296
Email: info.nj@nomistar.net



NomiStar Inc.

1043 N Lombard Rd
Lombard, IL 60148
Phone: 630-261-9300/877-261-9333
Fax: 630-261-0061/866-633-7755
Email: info.il@nomistar.net

Clutch Selection Guide

Clutch	Max Weight	Tube Size	Max Width
R8	8 lbs	1.25"	114"
		1.5"	132"
R16	16 lbs	1.5"	132"
	12 lbs	2"	168"
R24	24 lbs	1.5"	132"
	18 lbs	2"	168"
Spring Assist	30 lbs	1.5"	determined by weight
		2"	determined by weight

Notes

Shade weight is determined by the length and width of the shade (including wrap for the tube and hembar), hembar type, & fabric selection.

Please contact our office if you need further assistance.

Spring Assist: \$50 Net Charge